

# COMPLETE STAND VERSION B (from 4 m<sup>2</sup>)



Leipziger  
Buchmesse



Example image  
ROW STAND, 4 m<sup>2</sup>

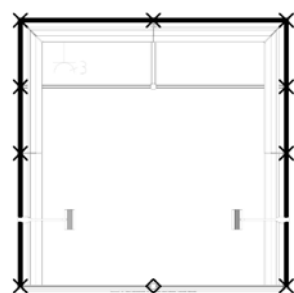

Floor plan  
ROW STAND, 4 m<sup>2</sup>



Example image  
CORNER STAND, 4 m<sup>2</sup>

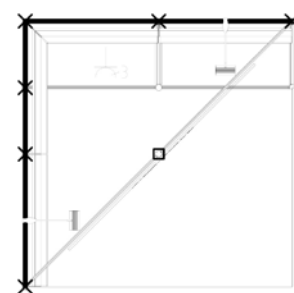

Floor plan  
CORNER STAND, 4 m<sup>2</sup>

## OUR STAND CONSTRUCTION SERVICES

- Support and frame elements, 250 cm high, 8-chamber groove system, white wall infill (other colors at an extra charge)
- 1x 2 m panel, 30 cm high on stand rear wall, white, optionally with panel lettering 25 letters, numbers, characters; height: 10 cm; font: Futura medium, color: dark grey; or panel logo based on a vectorized graphic file
- Book holders white, 4 pieces per wall element on top of each other (number customizable on request)
- Pedestals with sliding doors, white (please order rack lock separately)
- 1 long-arm spotlight per 2 m<sup>2</sup> of floor space
- 1 triple socket (power connection is charged separately)
- anthracite textile floor covering

## ADDITIONAL SERVICES

Depending on the size of your registered stand, you will receive a contingent of free exhibitor passes and the opportunity to register events in the program. Further information can be found in the Special Conditions of Participation.

Calculation example for a 4 m <sup>2</sup> exhibition stand *	Registration by 18.08.2025 (Special price)	Registration 19.08.-01.11.25 (Basic price)
Trade fair rental incl. stand construction	€840	€924
Sustainability fee	€26	€26
Marketing basic package	€98	€98
Electrical connection (2 kW incl. electricity consumption)	€196	€196
AUMA fee	€2.40	€2.40
Free exhibitor passes (according to area key)	2 passes	2 passes
<b>TOTAL PRICE</b>	<b>€ 1,162.40</b>	<b>€ 1,246.40</b>

# COMPLETE STAND VERSION B (from 4 m<sup>2</sup>)



Leipziger  
Buchmesse



Example image  
ROW STAND, 6 m<sup>2</sup>



Floor plan  
ROW STAND, 6 m<sup>2</sup>



Example image  
CORNER STAND, 6 m<sup>2</sup>

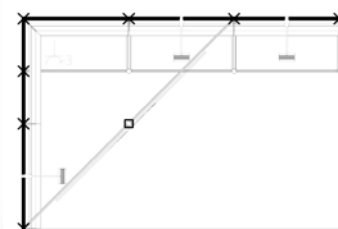

Floor plan  
CORNER STAND, 6 m<sup>2</sup>

## OUR STAND CONSTRUCTION SERVICES

- Support and frame elements, 250 cm high, 8-chamber groove system, white wall infill (other colors at an extra charge)
- 1x 2 m panel, 30 cm high on stand rear wall, white, optionally with panel lettering 25 letters, numbers, characters; height: 10 cm; font: Futura medium, color: dark grey; or panel logo based on a vectorized graphic file
- Book holders white, 4 pieces per wall element on top of each other (number customizable on request)
- Pedestals with sliding doors, white (please order rack lock separately)
- 1 long-arm spotlight per 2 m<sup>2</sup> of floor space
- 1 triple socket (power connection is charged separately)
- anthracite textile floor covering

## ADDITIONAL SERVICES

Depending on the size of your registered stand, you will receive a contingent of free exhibitor passes and the opportunity to register events in the program. Further information can be found in the Special Conditions of Participation.

Calculation example for a 6 m <sup>2</sup> exhibition stand *	Registration by 18.08.2025 (Special price)	Registration 19.08.-01.11.25 (Basic price)
Trade fair rental incl. stand construction	€1,350	€1,482
Sustainability fee	€39	€39
Marketing basic package	€98	€98
Electrical connection (2 kW incl. electricity consumption)	€196	€196
AUMA fee	€3.60	€3.60
Free exhibitor passes (according to area key)	3 passes	3 passes
<b>TOTAL PRICE</b>	<b>€ 1,686.60</b>	<b>€ 1,818.60</b>

# COMPLETE STAND VERSION B (from 4 m<sup>2</sup>)



Leipziger  
Buchmesse



Example image  
ROW STAND, 8 m<sup>2</sup>

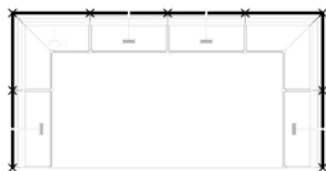

Floor plan  
ROW STAND, 8 m<sup>2</sup>



Example image  
CORNER STAND, 8 m<sup>2</sup>



Floor plan  
CORNER STAND, 8 m<sup>2</sup>

## OUR STAND CONSTRUCTION SERVICES

- Support and frame elements, 250 cm high, 8-chamber groove system, white wall infill (other colors at an extra charge)
- 1x 2 m panel, 30 cm high on stand rear wall, white, optionally with panel lettering 25 letters, numbers, characters; height: 10 cm; font: Futura medium, color: dark grey; or panel logo based on a vectorized graphic file
- All-round book holders white, 4 pieces per wall element on top of each other (number customizable on request)
- All-round pedestals with sliding doors, white (please order rack lock separately)
- 1 long-arm spotlight per 2 m<sup>2</sup> of floor space
- 1 triple socket (power connection is charged separately)
- anthracite textile floor covering

## ADDITIONAL SERVICES

Depending on the size of your registered stand, you will receive a contingent of free exhibitor passes and the opportunity to register events in the program. Further information can be found in the Special Conditions of Participation.

Calculation example for a 8 m <sup>2</sup> exhibition stand *	Registration by 18.08.2025 (Special price)	Registration 19.08.-01.11.25 (Basic price)
Trade fair rental incl. stand construction	€3,920	€4,304
Sustainability fee	€52	€52
Marketing basic package	€219	€219
Electrical connection (2 kW incl. electricity consumption)	€257	€257
AUMA fee	€4.80	€4.80
Free exhibitor passes (according to area key)	4 passes	4 passes
<b>TOTAL PRICE</b>	<b>€ 4,452.80</b>	<b>€ 4,836.80</b>

# COMPLETE STAND VERSION B (from 4 m<sup>2</sup>)



Example image  
ROW STAND, 15 m<sup>2</sup>



Floor plan  
ROW STAND, 15 m<sup>2</sup>



Example image  
CORNER STAND, 15 m<sup>2</sup>



Floor plan  
CORNER STAND, 15 m<sup>2</sup>

## OUR STAND CONSTRUCTION SERVICES

- Support and frame elements, 250 cm high, 8-chamber groove system, white wall infill (other colors at an extra charge)
- 1x 2 m panel, 30 cm high on stand rear wall, white, optionally with panel lettering 25 letters, numbers, characters; height: 10 cm; font: Futura medium, color: dark grey; or panel logo based on a vectorized graphic file
- All-round book holders white, 4 pieces per wall element on top of each other (number customizable on request)
- All-round pedestals with sliding doors, white (please order rack lock separately)
- 1 long-arm spotlight per 2 m<sup>2</sup> of floor space
- 1 triple socket (power connection is charged separately)
- anthracite textile floor covering

## ADDITIONAL SERVICES

Depending on the size of your registered stand, you will receive a contingent of free exhibitor passes and the opportunity to register events in the program. Further information can be found in the Special Conditions of Participation.

Calculation example for a 15 m <sup>2</sup> exhibition stand *	Registration by 18.08.2025 (Special price)	Registration 19.08.-01.11.25 (Basic price)
Trade fair rental incl. stand construction	€7,350	€8,070
Sustainability fee	€97.50	€97.50
Marketing basic package	€219	€219
Electrical connection (2 kW incl. electricity consumption)	€257	€257
AUMA fee	€9	€9
Free exhibitor passes (according to area key)	4 passes	4 passes
<b>TOTAL PRICE</b>	<b>€ 7,932.50</b>	<b>€ 8,652.50</b>